

Item	Part Number	List Price	Specifications	Dimensions
------	-------------	------------	----------------	------------

## DOOR ACCESSORIES

### BR7001

S Knocker



- 9BR7001-001** Venetian Bronze 112
- 9BR7001-002** Satin Nickel 150
- 9BR7001-003** Polished Chrome 260
- 9BR7001-004** Polished Brass 003
- 9BR7001-005** Matte Antique Nickel 152
- 9BR7001-006** Matte Brass & Black 049
- 9BR7001-009** Polished Nickel 141
- 9BR7001-010** Satin Black 190

\$62.50

- Solid brass construction
- Available as a complete set with mounting hardware, installation instructions and drill template
- Mounted with through-holes and fits 1-3/4" doors
- Uses 10-24 thru-bolts
- Weight: 1.49 lbs.

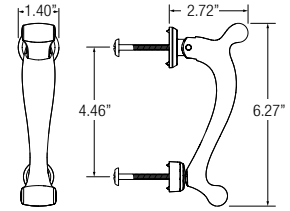

### BR7002

Contemporary Knocker



- 9BR7002-001** Venetian Bronze 112
- 9BR7002-002** Satin Nickel 150
- 9BR7002-003** Polished Chrome 260
- 9BR7002-009** Polished Nickel 141
- 9BR7002-010** Satin Black 190

\$62.50

- Solid brass construction
- Available as a complete set with mounting hardware, installation instructions and drill template
- Mounted with through-holes and fits 1-3/4" doors
- Uses 10-24 thru-bolts
- Weight: 1.05 lbs.

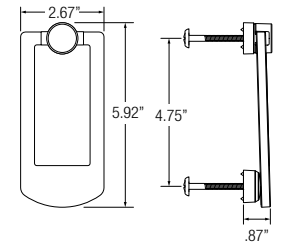

### BR7003

Ring Knocker



- 9BR7003-001** Venetian Bronze 112
- 9BR7003-002** Satin Nickel 150
- 9BR7003-003** Polished Chrome 260
- 9BR7003-004** Polished Brass 003
- 9BR7003-005** Matte Antique Nickel 152
- 9BR7003-006** Matte Brass & Black 049
- 9BR7003-007** Dark Bronze 481
- 9BR7003-008** White Bronze 492
- 9BR7003-009** Polished Nickel 141
- 9BR7003-010** Satin Black 190

\$62.50

- Solid brass construction
- Available as a complete set with mounting hardware, installation instructions and drill template
- Mounted with through-holes and fits 1-3/4" doors
- Uses 10-24 thru-bolts
- Weight: 1.21 lbs.

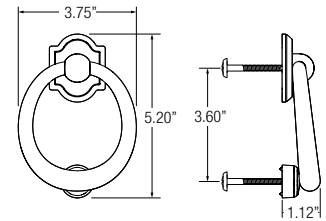

### BR7015

Rectangular Bell Button



- 9BR7015-001** Venetian Bronze 112
- 9BR7015-002** Satin Nickel 150
- 9BR7015-003** Polished Chrome 260
- 9BR7015-004** Polished Brass 003
- 9BR7015-005** Matte Antique Nickel 152
- 9BR7015-006** Matte Brass & Black 049
- 9BR7015-010** Satin Black 190

\$38.50

- Brass construction with concealed fasteners
- Illuminated button for easy detection at night
- Recommended for use with up to 24 volt transformers
- Available as a complete set with mounting hardware
- Weight: 0.025 lbs.

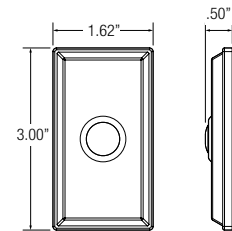

### BR7016

Oval Bell Button



- 9BR7016-001** Venetian Bronze 112
- 9BR7016-002** Satin Nickel 150
- 9BR7016-003** Polished Chrome 260
- 9BR7016-004** Polished Brass 003
- 9BR7016-005** Matte Antique Nickel 152
- 9BR7016-006** Matte Brass & Black 049
- 9BR7016-007** Satin Black 190

\$38.50

- Brass construction with concealed fasteners
- Illuminated button for easy detection at night
- Recommended for use with up to 24 volt transformers
- Available as a complete set with mounting hardware
- Weight: 0.025 lbs.

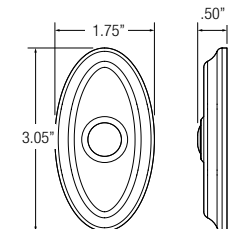

Item	Part Number	List Price	Specifications	Dimensions
------	-------------	------------	----------------	------------

## DOOR ACCESSORIES

**BR7017**  
Arch Bell Button



<b>9BR7017-001</b> Venetian Bronze 112	\$38.50
<b>9BR7017-002</b> Satin Nickel 150	
<b>9BR7017-003</b> Polished Chrome 260	
<b>9BR7017-004</b> Polished Brass 003	
<b>9BR7017-005</b> Matte Antique Nickel 152	
<b>9BR7017-006</b> Matte Brass & Black 049	
<b>9BR7017-007</b> Dark Bronze 481	
<b>9BR7017-008</b> White Bronze 492	
<b>9BR7017-009</b> Satin Black 190	

- Brass construction with concealed fasteners
- Illuminated button for easy detection at night
- Recommended for use with up to 24 volt transformers
- Available as a complete set with mounting hardware
- Weight: 0.025 lbs.

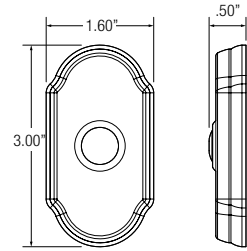

**BR7004**  
Observascope



<b>9BR7004-001</b> Venetian Bronze 112	\$20.50
<b>9BR7004-002</b> Satin Nickel 150	
<b>9BR7004-003</b> Polished Chrome 260	
<b>9BR7004-004</b> Polished Brass 003	

- Brass construction
- Provides one-way 170 degree angle visitor identification before entry
- Adjusts for use on 1.38" to 2.16" thick doors
- Bore hole diameter: 9/16"
- UL certified

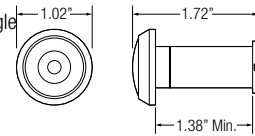

**BR7012**  
Edge Pull



<b>9BR7012-001</b> Venetian Bronze 112	\$19.50
<b>9BR7012-002</b> Satin Nickel 150	
<b>9BR7012-003</b> Polished Chrome 260	
<b>9BR7012-004</b> Polished Brass 003	
<b>9BR7012-005</b> Matte Antique Nickel 152	
<b>9BR7012-006</b> Matte Brass & Black 049	

- Brass construction
- Ideal for use on 1" or thicker doors
- Curved finger pull provides easy installation and use
- 1.32" pull projection

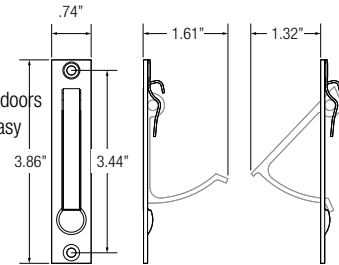

**BR7018**  
Ball Catch



<b>9BR7018-001</b> Venetian Bronze 112	\$22.50
<b>9BR7018-002</b> Satin Nickel 150	
<b>9BR7018-003</b> Polished Chrome 260	
<b>9BR7018-004</b> Polished Brass 003	
<b>9BR7018-005</b> Matte Antique Nickel 152	
<b>9BR7018-006</b> Matte Brass & Black 049	

- For use on louvered, bi-folding, accordion, closet and light to medium service doors
- Ball adjusts for door gap and latch tension
- Brass construction with steel ball
- Available as a complete set with mounting hardware

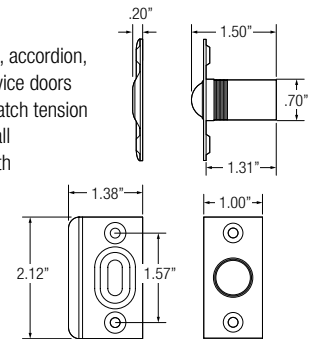

**BR7020**  
Flush Bolt



<b>9BR7020-001</b> Venetian Bronze 112	\$17.50
<b>9BR7020-002</b> Satin Nickel 150	
<b>9BR7020-003</b> Polished Chrome 260	
<b>9BR7020-004</b> Polished Brass 003	
<b>9BR7020-005</b> Matte Antique Nickel 152	
<b>9BR7020-006</b> Matte Brass & Black 049	

- Solid brass construction
- Features .94" extension bolt throw
- Smooth working action for easy operation
- Ideal for securing the inactive leaf of double doors
- Available as a complete set with strike, mounting hardware and installation instructions

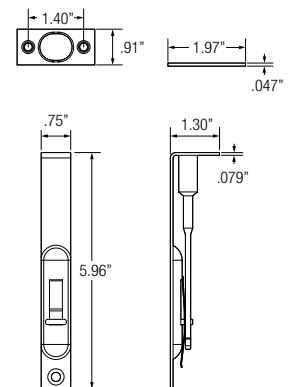

Item	Part Number	List Price	Specifications	Dimensions
------	-------------	------------	----------------	------------

## DOOR ACCESSORIES

### BR7021

Surface Bolt 6"



- 9BR7021-001** Venetian Bronze 112
- 9BR7021-002** Satin Nickel 150
- 9BR7021-003** Polished Chrome 260
- 9BR7021-004** Polished Brass 003
- 9BR7021-005** Matte Antique Nickel 152
- 9BR7021-006** Matte Brass & Black 049

\$33.50

- Solid brass construction
- Ideal for securing doors, casement windows, cabinets and drawers
- Furnished with both universal and mortise strikes
- Solid brass mounting screws are concealed

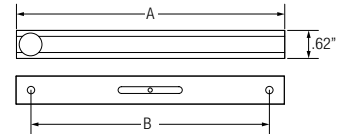
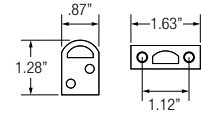

	A	B
Surface Bolt 6"	6"	5.25"
Surface Bolt 4"	4"	3.27"

### BR7022

Surface Bolt 4"



- 9BR7022-001** Venetian Bronze 112
- 9BR7022-002** Satin Nickel 150
- 9BR7022-003** Polished Chrome 260
- 9BR7022-004** Polished Brass 003
- 9BR7022-005** Matte Antique Nickel 152
- 9BR7022-006** Matte Brass & Black 049

\$30.50

- Features .69" extension bolt throw and .67" knob projection from door

## WINDOW HARDWARE

### BR7013

Flush Pull



- 9BR7013-001** Venetian Bronze 112
- 9BR7013-002** Satin Nickel 150
- 9BR7013-003** Polished Chrome 260
- 9BR7013-004** Polished Brass 003
- 9BR7013-005** Matte Antique Nickel 152
- 9BR7013-006** Matte Brass & Black 049

\$21.50

- Brass construction
- For use on large or heavy sliding doors and panels
- Available as a complete set with mounting hardware and installation instructions

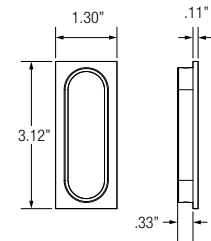

### BR7014

Sash Lock



- 9BR7014-001** Venetian Bronze 112
- 9BR7014-002** Satin Nickel 150
- 9BR7014-003** Polished Chrome 260
- 9BR7014-004** Polished Brass 003
- 9BR7014-005** Matte Antique Nickel 152
- 9BR7014-006** Matte Brass & Black 049

\$21.50

- Solid brass construction
- Secures and helps prevent air movement around double hung windows
- Available as a complete set with mounting hardware

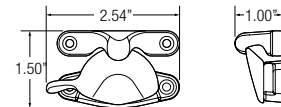

### BR7019

Sash Lift



- 9BR7019-001** Venetian Bronze 112
- 9BR7019-002** Satin Nickel 150
- 9BR7019-003** Polished Chrome 260
- 9BR7019-004** Polished Brass 003
- 9BR7019-005** Matte Antique Nickel 152
- 9BR7019-006** Matte Brass & Black 049

\$20.50

- Solid brass construction
- Ideal for use on double hung windows
- Can also function as a door, cabinet or drawer pull
- Projection: .97"
- Includes mounting hardware

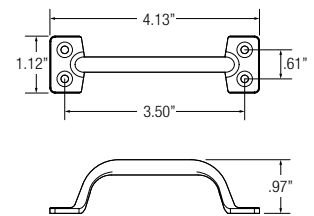

Item	Part Number	List Price	Specifications	Dimensions
------	-------------	------------	----------------	------------

## DOOR STOPS



- 9BR7005-001** Venetian Bronze 112
- 9BR7005-002** Satin Nickel 150
- 9BR7005-003** Polished Chrome 260
- 9BR7005-004** Polished Brass 003
- 9BR7005-005** Matte Antique Nickel 152
- 9BR7005-006** Matte Brass & Black 049

\$16.00

- Brass construction
- Heavy design helps prevent damage to walls
- Pre-installed stud and slotted tip for easy installation

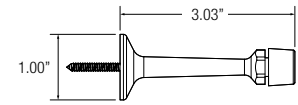

\*Note: All tip and bumper pieces are grey durable rubber

**BR7006**  
Wall Bumper 1" (Convex)



- 9BR7006-001** Venetian Bronze 112
- 9BR7006-002** Satin Nickel 150
- 9BR7006-003** Polished Chrome 260
- 9BR7006-004** Polished Brass 003
- 9BR7006-005** Matte Antique Nickel 152
- 9BR7006-006** Matte Brass & Black 049

\$16.00

- Brass collar
- Convex surface with durable rubber bumper for long operating life
- Includes mounting hardware and installation instructions

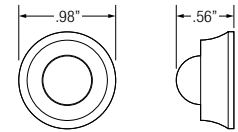

\*Note: All tip and bumper pieces are grey durable rubber

**BR7029**  
Wall Bumper 2.4" (Convex)



- 9BR7029-001** Venetian Bronze 112
- 9BR7029-002** Satin Nickel 150
- 9BR7029-003** Polished Chrome 260
- 9BR7029-004** Polished Brass 003
- 9BR7029-005** Matte Antique Nickel 152
- 9BR7029-006** Matte Brass & Black 049

\$16.00

- Brass collar
- Convex surface with durable rubber bumper for long operating life
- Includes mounting hardware and installation instructions

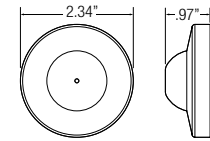

\*Note: All tip and bumper pieces are grey durable rubber

**BR7007**  
Wall Bumper 2.4" (Concave)



- 9BR7007-001** Venetian Bronze 112
- 9BR7007-002** Satin Nickel 150
- 9BR7007-003** Polished Chrome 260
- 9BR7007-004** Polished Brass 003
- 9BR7007-005** Matte Antique Nickel 152
- 9BR7007-006** Matte Brass & Black 049

\$16.00

- Brass collar
- Concave surface with durable rubber bumper for long operating life
- Includes mounting hardware and installation instructions

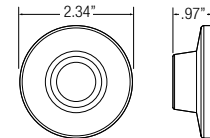

\*Note: All tip and bumper pieces are grey durable rubber

**BR7008**  
Floor Bumper .38"



- 9BR7008-001** Venetian Bronze 112
- 9BR7008-002** Satin Nickel 150
- 9BR7008-003** Polished Chrome 260
- 9BR7008-004** Polished Brass 003
- 9BR7008-005** Matte Antique Nickel 152
- 9BR7008-006** Matte Brass & Black 049

\$16.50

- Solid brass shell
- Stops door and prevents damage to wall and doors
- Positive stopping action provided by non-marring bumper
- Designed for undercut doors or doors without threshold
- Includes installation instructions and plastic anchor for concrete floor installation

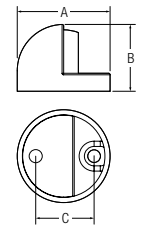

	A	B	C
--	---	---	---











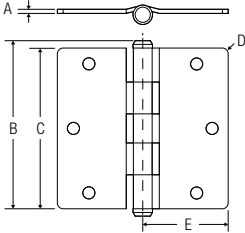

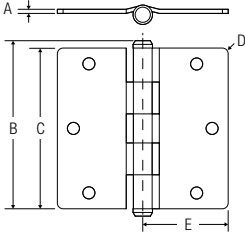
Floor Bumper .38"	1.77"	1.24"	1.12"
Floor Bumper .13"	1.77"	1.09"	1.12"

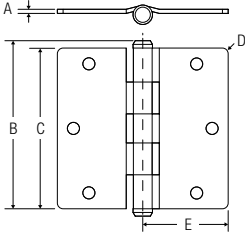
**BR7009**  
Floor Bumper .13"

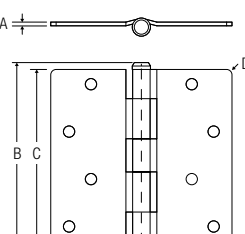

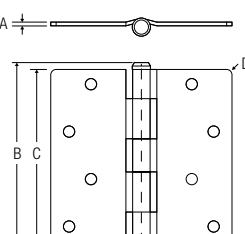
- 9BR7009-001** Venetian Bronze 112
- 9BR7009-002** Satin Nickel 150
- 9BR7009-003** Polished Chrome 260
- 9BR7009-004** Polished Brass 003
- 9BR7009-005** Matte Antique Nickel 152
- 9BR7009-006** Matte Brass & Black 049

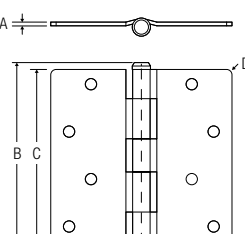
\*Note: All tip and bumper pieces are grey durable rubber

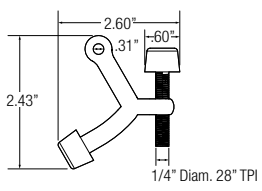
Item	Part Number	List Price	Specifications	Dimensions																				
<b>HINGES</b>																								
<b>BR7023</b> 3.5" 1/4" Radius 	<b>9BR7023-001</b> Venetian Bronze 112	\$18.50	<ul style="list-style-type: none"> <li>• Solid brass construction designed for residential door applications</li> <li>• Five knuckle, friction fit design with brass headed pin</li> <li>• Non-rising pin with hole in bottom tip for easy removal</li> <li>• Available as a complete set with mounting hardware</li> <li>• Ordered and packed one (1) hinge per box</li> <li>• Hinges ship dry to prevent chemical contamination on doors or wood jambs before finishing</li> <li>• Weight: 0.46 lbs.</li> </ul>	<div style="border: 1px solid black; padding: 5px; margin-bottom: 10px;"> <b>Care &amp; Maintenance</b> <ul style="list-style-type: none"> <li>• Recommended to lubricate hinge pin with heavy bearing grease</li> <li>• To lubricate, extract pin and wipe or dip with grease. Reinsert pin. Grease will work into load bearing surface. Wipe excess grease and dirt from hinge</li> </ul> </div>  <table border="1" style="width: 100%; text-align: center;"> <thead> <tr> <th>A</th> <th>B</th> <th>C</th> <th>D</th> <th>E</th> </tr> </thead> <tbody> <tr> <td>.08"</td> <td>3.82"</td> <td>3.5"</td> <td>.25"</td> <td>1.86"</td> </tr> <tr> <td>.08"</td> <td>3.82"</td> <td>3.5"</td> <td>.625"</td> <td>1.86"</td> </tr> <tr> <td>.08"</td> <td>3.83"</td> <td>3.5"</td> <td>N/A</td> <td>1.86"</td> </tr> </tbody> </table>	A	B	C	D	E	.08"	3.82"	3.5"	.25"	1.86"	.08"	3.82"	3.5"	.625"	1.86"	.08"	3.83"	3.5"	N/A	1.86"
	A				B	C	D	E																
	.08"				3.82"	3.5"	.25"	1.86"																
	.08"				3.82"	3.5"	.625"	1.86"																
	.08"				3.83"	3.5"	N/A	1.86"																
	<b>9BR7023-002</b> Satin Nickel 150																							
	<b>9BR7023-003</b> Polished Chrome 260																							
	<b>9BR7023-004</b> Polished Brass 003																							
	<b>9BR7023-005</b> Matte Antique Nickel 152																							
	<b>9BR7023-006</b> Matte Brass & Black 049																							
<b>9BR7023-010</b> Satin Black 190																								
<b>BR7024</b> 3.5" 5/8" Radius 	<b>9BR7024-001</b> Venetian Bronze 112	\$18.50	<ul style="list-style-type: none"> <li>• Solid brass construction designed for residential door applications</li> <li>• Five knuckle, friction fit design with brass headed pin</li> <li>• Non-rising pin with hole in bottom tip for easy removal</li> <li>• Available as a complete set with mounting hardware</li> <li>• Ordered and packed one (1) hinge per box</li> <li>• Hinges ship dry to prevent chemical contamination on doors or wood jambs before finishing</li> <li>• Weight: 0.46 lbs.</li> </ul>	<div style="border: 1px solid black; padding: 5px; margin-bottom: 10px;"> <b>Care &amp; Maintenance</b> <ul style="list-style-type: none"> <li>• Recommended to lubricate hinge pin with heavy bearing grease</li> <li>• To lubricate, extract pin and wipe or dip with grease. Reinsert pin. Grease will work into load bearing surface. Wipe excess grease and dirt from hinge</li> </ul> </div>  <table border="1" style="width: 100%; text-align: center;"> <thead> <tr> <th>A</th> <th>B</th> <th>C</th> <th>D</th> <th>E</th> </tr> </thead> <tbody> <tr> <td>.08"</td> <td>3.82"</td> <td>3.5"</td> <td>.25"</td> <td>1.86"</td> </tr> <tr> <td>.08"</td> <td>3.82"</td> <td>3.5"</td> <td>.625"</td> <td>1.86"</td> </tr> <tr> <td>.08"</td> <td>3.83"</td> <td>3.5"</td> <td>N/A</td> <td>1.86"</td> </tr> </tbody> </table>	A	B	C	D	E	.08"	3.82"	3.5"	.25"	1.86"	.08"	3.82"	3.5"	.625"	1.86"	.08"	3.83"	3.5"	N/A	1.86"
	A				B	C	D	E																
	.08"				3.82"	3.5"	.25"	1.86"																
	.08"				3.82"	3.5"	.625"	1.86"																
	.08"				3.83"	3.5"	N/A	1.86"																
	<b>9BR7024-002</b> Satin Nickel 150																							
	<b>9BR7024-003</b> Polished Chrome 260																							
	<b>9BR7024-004</b> Polished Brass 003																							
	<b>9BR7024-005</b> Matte Antique Nickel 152																							
	<b>9BR7024-006</b> Matte Brass & Black 049																							
<b>9BR7024-010</b> Satin Black 190																								
<b>BR7025</b> 3.5" Square 	<b>9BR7025-001</b> Venetian Bronze 112	\$18.50	<ul style="list-style-type: none"> <li>• Solid brass construction designed for residential door applications</li> <li>• Five knuckle, friction fit design with brass headed pin</li> <li>• Non-rising pin with hole in bottom tip for easy removal</li> <li>• Available as a complete set with mounting hardware</li> <li>• Ordered and packed one (1) hinge per box</li> <li>• Hinges ship dry to prevent chemical contamination on doors or wood jambs before finishing</li> <li>• Weight: 0.46 lbs.</li> </ul>	<div style="border: 1px solid black; padding: 5px; margin-bottom: 10px;"> <b>Care &amp; Maintenance</b> <ul style="list-style-type: none"> <li>• Recommended to lubricate hinge pin with heavy bearing grease</li> <li>• To lubricate, extract pin and wipe or dip with grease. Reinsert pin. Grease will work into load bearing surface. Wipe excess grease and dirt from hinge</li> </ul> </div>  <table border="1" style="width: 100%; text-align: center;"> <thead> <tr> <th>A</th> <th>B</th> <th>C</th> <th>D</th> <th>E</th> </tr> </thead> <tbody> <tr> <td>.08"</td> <td>3.82"</td> <td>3.5"</td> <td>.25"</td> <td>1.86"</td> </tr> <tr> <td>.08"</td> <td>3.82"</td> <td>3.5"</td> <td>.625"</td> <td>1.86"</td> </tr> <tr> <td>.08"</td> <td>3.83"</td> <td>3.5"</td> <td>N/A</td> <td>1.86"</td> </tr> </tbody> </table>	A	B	C	D	E	.08"	3.82"	3.5"	.25"	1.86"	.08"	3.82"	3.5"	.625"	1.86"	.08"	3.83"	3.5"	N/A	1.86"
	A				B	C	D	E																
	.08"				3.82"	3.5"	.25"	1.86"																
	.08"				3.82"	3.5"	.625"	1.86"																
	.08"				3.83"	3.5"	N/A	1.86"																
	<b>9BR7025-002</b> Satin Nickel 150																							
	<b>9BR7025-003</b> Polished Chrome 260																							
	<b>9BR7025-004</b> Polished Brass 003																							
	<b>9BR7025-005</b> Matte Antique Nickel 152																							
	<b>9BR7025-006</b> Matte Brass & Black 049																							
<b>9BR7025-010</b> Satin Black 190																								
<b>BR7026</b> 4" 1/4" Radius 	<b>9BR7026-001</b> Venetian Bronze 112	\$20.50	<ul style="list-style-type: none"> <li>• Solid brass construction designed for residential door applications</li> <li>• Five knuckle, friction fit design with brass headed pin</li> <li>• Non-rising pin with hole in bottom tip for easy removal</li> <li>• Available as a complete set with mounting hardware</li> <li>• Ordered and packed one (1) hinge per box</li> <li>• Hinges ship dry to prevent chemical contamination on doors or wood jambs before finishing</li> <li>• Weight: 0.59 lbs.</li> </ul>	<div style="border: 1px solid black; padding: 5px; margin-bottom: 10px;"> <b>Care &amp; Maintenance</b> <ul style="list-style-type: none"> <li>• Recommended to lubricate hinge pin with heavy bearing grease</li> <li>• To lubricate, extract pin and wipe or dip with grease. Reinsert pin. Grease will work into load bearing surface. Wipe excess grease and dirt from hinge</li> </ul> </div>  <table border="1" style="width: 100%; text-align: center;"> <thead> <tr> <th>A</th> <th>B</th> <th>C</th> <th>D</th> <th>E</th> </tr> </thead> <tbody> <tr> <td>.09"</td> <td>4.32"</td> <td>4"</td> <td>.25"</td> <td>2.11"</td> </tr> <tr> <td>.09"</td> <td>4.32"</td> <td>4"</td> <td>.625"</td> <td>2.11"</td> </tr> <tr> <td>.09"</td> <td>4.32"</td> <td>4"</td> <td>N/A</td> <td>2.11"</td> </tr> </tbody> </table>	A	B	C	D	E	.09"	4.32"	4"	.25"	2.11"	.09"	4.32"	4"	.625"	2.11"	.09"	4.32"	4"	N/A	2.11"
	A				B	C	D	E																
	.09"				4.32"	4"	.25"	2.11"																
	.09"				4.32"	4"	.625"	2.11"																
	.09"				4.32"	4"	N/A	2.11"																
	<b>9BR7026-002</b> Satin Nickel 150																							
	<b>9BR7026-003</b> Polished Chrome 260																							
	<b>9BR7026-004</b> Polished Brass 003																							
	<b>9BR7026-005</b> Matte Antique Nickel 152																							
	<b>9BR7026-006</b> Matte Brass & Black 049																							
<b>9BR7026-010</b> Satin Black 190																								
<b>BR7027</b> 4" 5/8" Radius 	<b>9BR7027-001</b> Venetian Bronze 112	\$20.50	<ul style="list-style-type: none"> <li>• Solid brass construction designed for residential door applications</li> <li>• Five knuckle, friction fit design with brass headed pin</li> <li>• Non-rising pin with hole in bottom tip for easy removal</li> <li>• Available as a complete set with mounting hardware</li> <li>• Ordered and packed one (1) hinge per box</li> <li>• Hinges ship dry to prevent chemical contamination on doors or wood jambs before finishing</li> <li>• Weight: 0.59 lbs.</li> </ul>	<div style="border: 1px solid black; padding: 5px; margin-bottom: 10px;"> <b>Care &amp; Maintenance</b> <ul style="list-style-type: none"> <li>• Recommended to lubricate hinge pin with heavy bearing grease</li> <li>• To lubricate, extract pin and wipe or dip with grease. Reinsert pin. Grease will work into load bearing surface. Wipe excess grease and dirt from hinge</li> </ul> </div>  <table border="1" style="width: 100%; text-align: center;"> <thead> <tr> <th>A</th> <th>B</th> <th>C</th> <th>D</th> <th>E</th> </tr> </thead> <tbody> <tr> <td>.09"</td> <td>4.32"</td> <td>4"</td> <td>.25"</td> <td>2.11"</td> </tr> <tr> <td>.09"</td> <td>4.32"</td> <td>4"</td> <td>.625"</td> <td>2.11"</td> </tr> <tr> <td>.09"</td> <td>4.32"</td> <td>4"</td> <td>N/A</td> <td>2.11"</td> </tr> </tbody> </table>	A	B	C	D	E	.09"	4.32"	4"	.25"	2.11"	.09"	4.32"	4"	.625"	2.11"	.09"	4.32"	4"	N/A	2.11"
	A				B	C	D	E																
	.09"				4.32"	4"	.25"	2.11"																
	.09"				4.32"	4"	.625"	2.11"																
	.09"				4.32"	4"	N/A	2.11"																
	<b>9BR7027-002</b> Satin Nickel 150																							
	<b>9BR7027-003</b> Polished Chrome 260																							
	<b>9BR7027-004</b> Polished Brass 003																							
	<b>9BR7027-005</b> Matte Antique Nickel 152																							
	<b>9BR7027-006</b> Matte Brass & Black 049																							
<b>9BR7027-010</b> Satin Black 190																								
<b>BR7028</b> 4" Square 	<b>9BR7028-001</b> Venetian Bronze 112	\$20.50	<ul style="list-style-type: none"> <li>• Solid brass construction designed for residential door applications</li> <li>• Five knuckle, friction fit design with brass headed pin</li> <li>• Non-rising pin with hole in bottom tip for easy removal</li> <li>• Available as a complete set with mounting hardware</li> <li>• Ordered and packed one (1) hinge per box</li> <li>• Hinges ship dry to prevent chemical contamination on doors or wood jambs before finishing</li> <li>• Weight: 0.59 lbs.</li> </ul>	<div style="border: 1px solid black; padding: 5px; margin-bottom: 10px;"> <b>Care &amp; Maintenance</b> <ul style="list-style-type: none"> <li>• Recommended to lubricate hinge pin with heavy bearing grease</li> <li>• To lubricate, extract pin and wipe or dip with grease. Reinsert pin. Grease will work into load bearing surface. Wipe excess grease and dirt from hinge</li> </ul> </div>  <table border="1" style="width: 100%; text-align: center;"> <thead> <tr> <th>A</th> <th>B</th> <th>C</th> <th>D</th> <th>E</th> </tr> </thead> <tbody> <tr> <td>.09"</td> <td>4.32"</td> <td>4"</td> <td>.25"</td> <td>2.11"</td> </tr> <tr> <td>.09"</td> <td>4.32"</td> <td>4"</td> <td>.625"</td> <td>2.11"</td> </tr> <tr> <td>.09"</td> <td>4.32"</td> <td>4"</td> <td>N/A</td> <td>2.11"</td> </tr> </tbody> </table>	A	B	C	D	E	.09"	4.32"	4"	.25"	2.11"	.09"	4.32"	4"	.625"	2.11"	.09"	4.32"	4"	N/A	2.11"
	A				B	C	D	E																
	.09"				4.32"	4"	.25"	2.11"																
	.09"				4.32"	4"	.625"	2.11"																
	.09"				4.32"	4"	N/A	2.11"																
	<b>9BR7028-002</b> Satin Nickel 150																							
	<b>9BR7028-003</b> Polished Chrome 260																							
	<b>9BR7028-004</b> Polished Brass 003																							
	<b>9BR7028-005</b> Matte Antique Nickel 152																							
	<b>9BR7028-006</b> Matte Brass & Black 049																							
<b>9BR7028-010</b> Satin Black 190																								
<b>BR7011</b> Hinge Pin Door Stop 	<b>9BR7011-001</b> Venetian Bronze 112	\$11.50	<ul style="list-style-type: none"> <li>• Solid brass construction</li> <li>• Adjustable to stop door at any angle with rubber pad making contact with door</li> <li>• Hinge pin door stop can be used with Reserve hinges only. Not compatible with Baldwin Estate hinges.</li> </ul>																					
	<b>9BR7011-002</b> Satin Nickel 150																							
	<b>9BR7011-003</b> Polished Chrome 260																							
	<b>9BR7011-004</b> Polished Brass 003																							
	<b>9BR7011-005</b> Matte Antique Nickel 152																							
	<b>9BR7011-006</b> Matte Brass & Black 049																							